

Part Number: PT347-52080

NOTE: Part number of this accessory may not be the same as the part number shown.

Kit Contents

Item #	Quantity Reqd.	Description
1	1	Convenience Net
2	1	Installation Instructions

Hardware Bag Contents

Item #	Quantity Reqd.	Description
1	2	T-Anchor
2	2	Sheet metal screw

Additional Items Required For Installation

Item #	Quantity Reqd.	Description
1		

Conflicts

--

Recommended Tools

Personal & Vehicle Protection	Notes
None	
Safety glasses	
Special Tools	Notes
None	
Installation Tools	Notes
Drill Motor	
Drill Bit	3.5mm
Drill Bit	10mm
Masking Tape	1" wide
Center Punch	
Drill Stop	
Drill Template	
Special Chemicals	Notes
None	

General Applicability

All 2008> Scion xB vehicles

Recommended Sequence of Application

Item #	Accessory
1	T-Anchor
2	Cargo Net
3	

*Mandatory

Vehicle Service Parts (may be required for reassembly)

Item #	Quantity Reqd.	Description
1		
2		
3		

Legend



STOP: Damage to the vehicle may occur. Do not proceed until process has been complied with.



OPERATOR SAFETY: Use caution to avoid risk of injury.



CAUTION: A process that must be carefully observed in order to reduce the risk of damage to the accessory/vehicle and to ensure a quality installation.



TOOLS & EQUIPMENT: Used in Figures calls out the specific tools and equipment recommended for this process.

Care must be taken when installing this accessory to ensure damage does not occur to the vehicle. The installation of this accessory should follow approved guidelines to ensure a quality installation.

These guidelines can be found in the "Accessory Installation Practices" document.

This document covers such items as:-

- Vehicle Protection (use of covers and blankets, cleaning chemicals, etc.).
- Safety (eye protection, rechecking torque procedure, etc.).
- Vehicle Disassembly/Reassembly (panel removal, part storage, etc.).
- Electrical Component Disassembly/Reassembly (battery disconnection, connector removal, etc.).

Please see your Toyota dealer for a copy of this document.

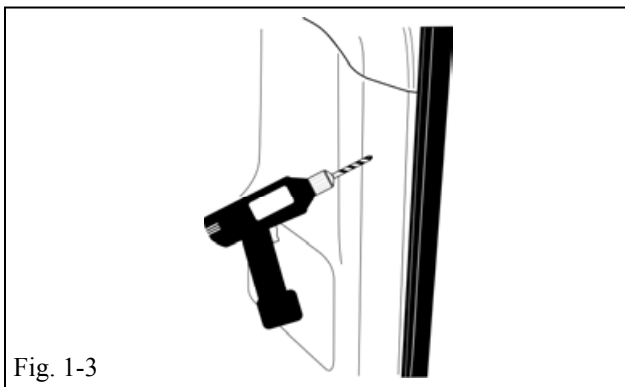
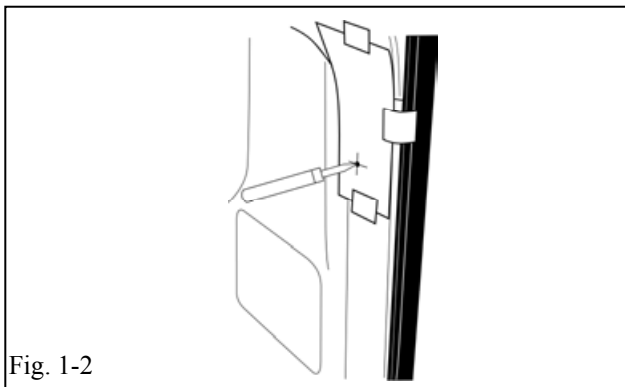
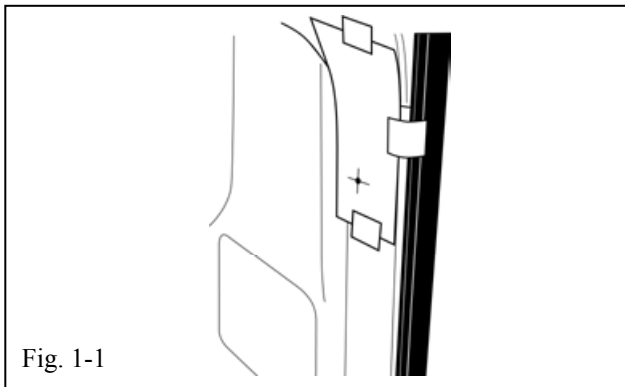

1. Installation of Cargo Net

(a) NOTE: Start on right side, align and attach drill template to panel with masking tape as shown (Fig 1-1).

(b) Center-punch the panel as indicated on the template (Fig 1-2).



(c) Carefully drill a 3.5mm hole through underlying plastic bracket (right side only) and sheet metal (Fig. 1-3). (Set Drill stop at 10 mm.)



(d) After drilling 3.5mm hole in underlying bracket/sheet metal, enlarge existing hole in trim panel using a 10mm drill bit (Fig. 1-4).

CAUTION: Drill 10mm HOLE IN OUTER PLASTIC ONLY.

NOTE: Use a drill step set at 4 mm

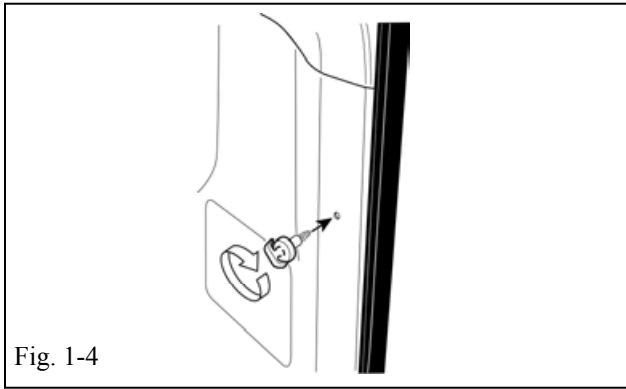

NOTE: Apply rust preventative to the screw tip.



(e) Screw new anchor assembly snugly into underlying sheet metal, ensuring anchor is horizontal after installation (Fig 1-4) & (Fig 1-5).

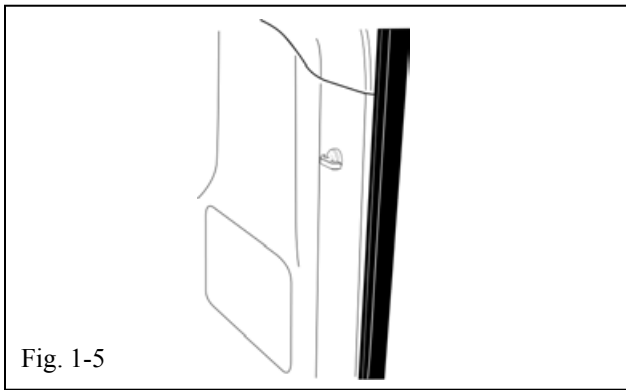

(f) Repeat above steps for the left side of vehicle.



(g) Attach the loop at the top of the net to the T-anchor, making sure the pouch is on the driver's side of the vehicle (Fig 1-6).

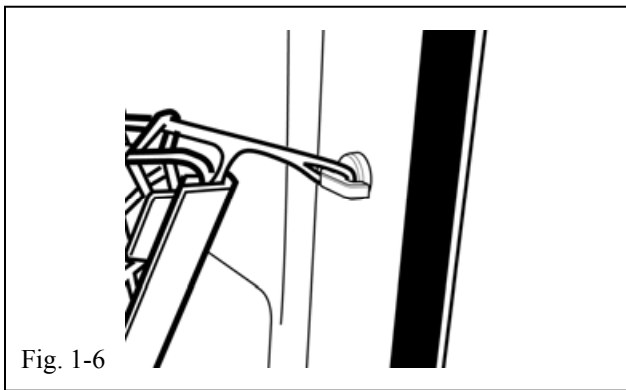

(h) Attach the hook at the bottom of the net to the D-ring on the floor (Fig 1-7).

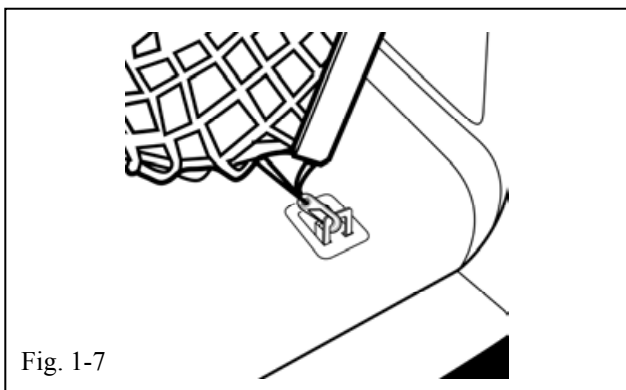

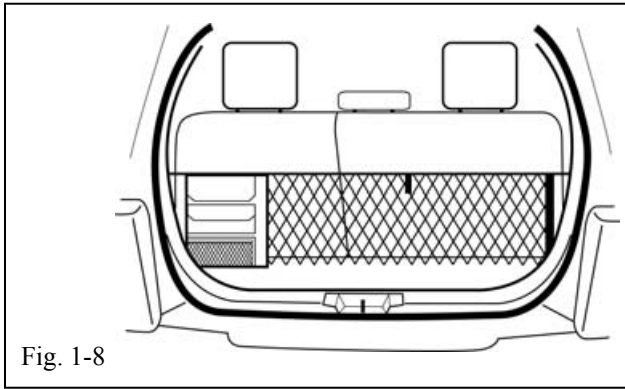

Fig. 1-8

(i) Completed assembly (Fig 1-8).

Checklist - these points **MUST** be checked to ensure a quality installation.

Check:

Look For:

Accessory Function Checks

- Confirm that the net is attached properly to the anchor points in the vehicle.

- Confirm that the anchors are attached properly to the vehicle.

- Confirm that the rear door closes.

Loops are attached to the anchors at the top.
 Hooks are attached to lower D-rings.

Make sure the T-anchors are in the horizontal position when tightened to the vehicle.

Rear door is completely shut.

**NOTE: This template is for the Passenger Side of the vehicle.
Please save & flip over for use on the Driver's side of the vehicle.**

