

Part Number: PT347-52081

NOTE: Part number of this accessory may not be the same as the part number shown.

Kit Contents

Item #	Quantity Reqd.	Description
1	1	Convenience Net
2	1	Installation Instructions

Hardware Bag Contents

Item #	Quantity Reqd.	Description
1	2	T-Anchor
2	2	Weld Stud

Additional Items Required For Installation

Item #	Quantity Reqd.	Description
1		

Conflicts

--

Recommended Tools

Personal & Vehicle Protection	Notes
Safety Glasses	
Special Tools	Notes
None	
Installation Tools	Notes
Drill Motor	
Drill Bit	6mm
Masking Tape	1" wide
Center Punch	
NRT Tool	
Drill Stop	
Special Chemicals	Notes
None	

General Applicability

All 2008> Scion xD vehicles

Recommended Sequence of Application





Item #	Accessory
1	T-Anchor / Weld Stud
2	Cargo Net
3	

*Mandatory

Vehicle Service Parts (may be required for reassembly)

Item #	Quantity Reqd.	Description
1		
2		
3		

Legend

	STOP: Damage to the vehicle may occur. Do not proceed until process has been complied with.
	OPERATOR SAFETY: Use caution to avoid risk of injury.
	CAUTION: A process that must be carefully observed in order to reduce the risk of damage to the accessory/vehicle and to ensure a quality installation.
	TOOLS & EQUIPMENT: Used in Figures calls out the specific tools and equipment recommended for this process.

Care must be taken when installing this accessory to ensure damage does not occur to the vehicle. The installation of this accessory should follow approved guidelines to ensure a quality installation.

These guidelines can be found in the "Accessory Installation Practices" document.

This document covers such items as:-

- Vehicle Protection (use of covers and blankets, cleaning chemicals, etc.).
- Safety (eye protection, rechecking torque procedure, etc.).
- Vehicle Disassembly/Reassembly (panel removal, part storage, etc.).
- Electrical Component Disassembly/Reassembly (battery disconnection, connector removal, etc.).

Please see your Toyota dealer for a copy of this document.

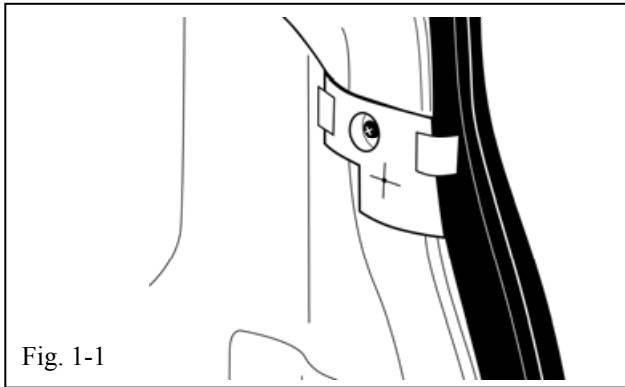

1. Installation of Cargo Net

- (a) NOTE: Start on right side, align and attach drill template to panel with masking tape as shown (Fig 1-1).
- (b) Center-punch the panel as indicated on the template (Fig 1-2).
-  (c) Remove template and carefully drill a 6 mm hole in the panel (Fig. 1-3).

NOTE: Use a drill stop set at 4 mm

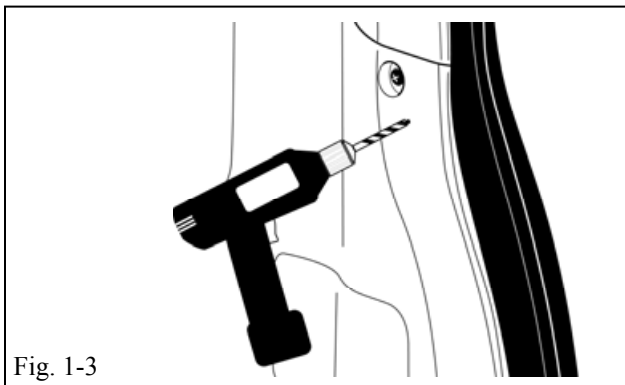
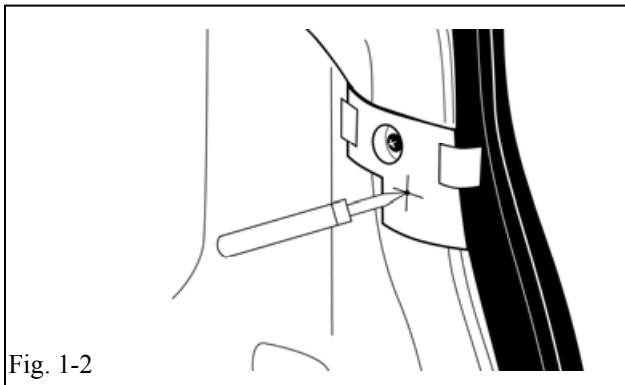

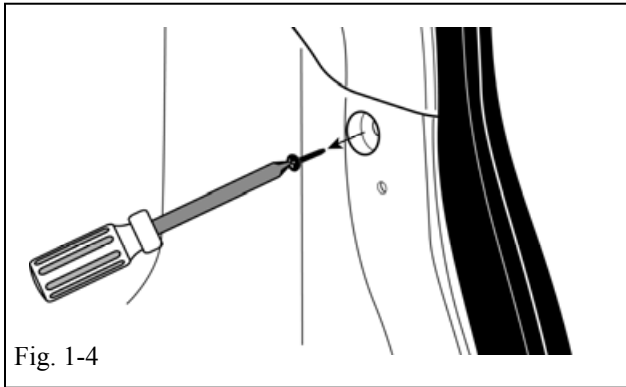

(d) Using a Philips head screwdriver, remove the screw from the panel (Fig 1-4).

 (e) Gently pull loose the rubber weatherstripping. Using an NRT, pull the panel out enough to allow the weld stud to be inserted. (Fig 1-5).



(f) Insert weld stud through drilled hole as shown (Fig 1-6).

 (g) Screw on the T-anchor and make sure it is horizontal when tightened snugly (Fig 1-7).

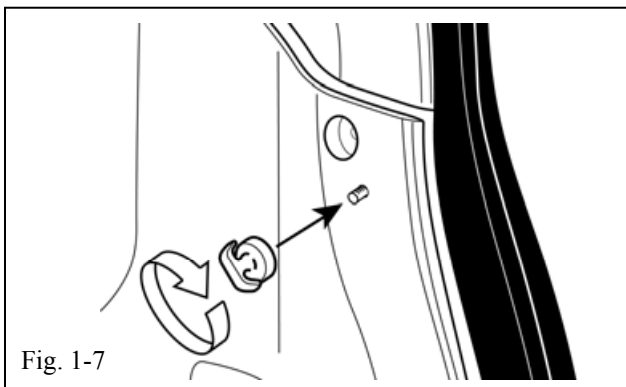
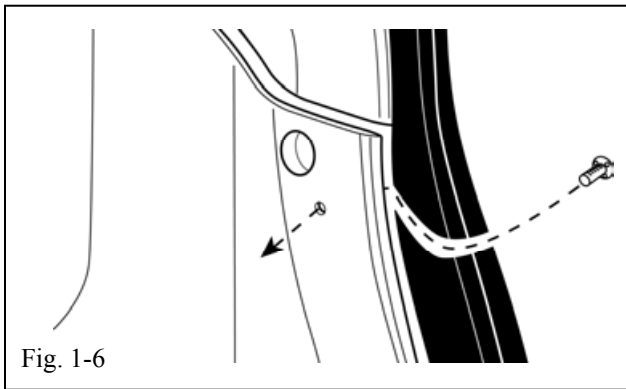

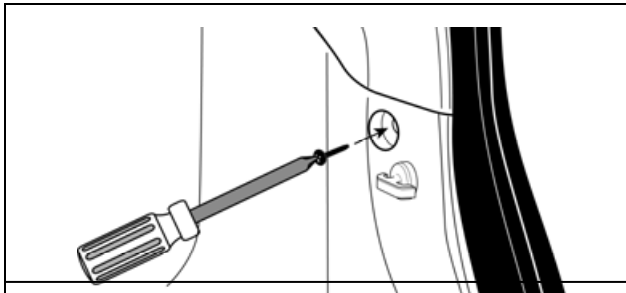

Fig. 1-8

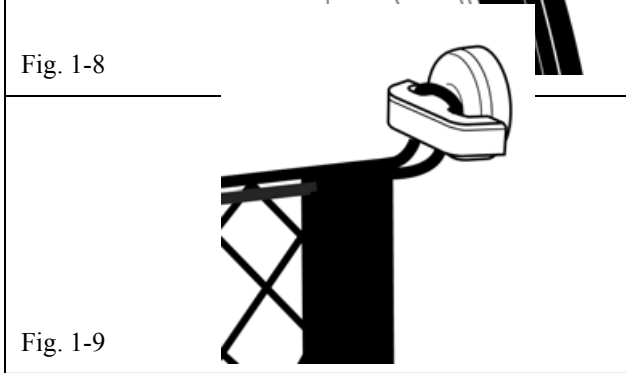

Fig. 1-9

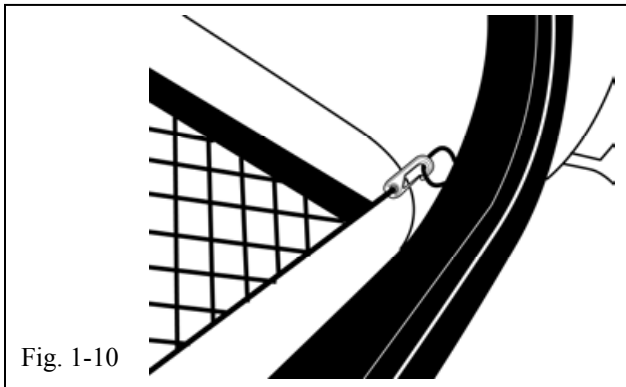

Fig. 1-10

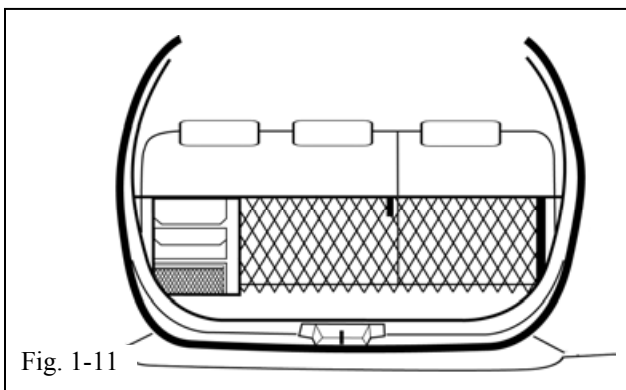



Fig. 1-11

(h) Carefully fasten panel back into place insuring panel clips are properly aligned with mounting location. Carefully re-install the weather-stripping. Using a Philips head screwdriver, re-install the screw into the panel (Fig 1-8).

(i) Repeat steps 1(a) through 1(h) on driver side. Use reverse side of drilling template for drill location.

(j) Install the loops at the top of the net to the installed T-anchors (Fig 1-9).

(k) Install the hooks at the bottom of the net to the lower D-rings (Fig 1-10).

 (l) Completed assembly. Make sure the pull handle faces rearward (Fig 1-11).

 (m) Attach the loop at the top of the net to the T-anchor, making sure the pouch is on the driver's side of the vehicle (Fig 1-11).

Checklist - these points **MUST** be checked to ensure a quality installation.

Check:

Look For:

Accessory Function Checks

- Confirm that the net is attached properly to the anchor points in the vehicle.

- Confirm that the anchors are attached properly to the vehicle.

- Confirm that the rear door closes.

Loops are attached to the anchors at the top.
 Hooks are attached to lower D-rings.

Make sure the T-anchors are in the horizontal position when tightened to the vehicle.

Rear door is completely shut.

**NOTE: This template is for the Passenger Side of the vehicle.
Please save & flip over for use on the Driver's side of the vehicle.**

